

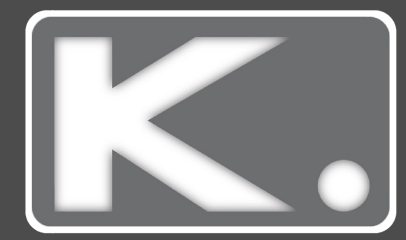

**2 Bed
House - Terraced
located
in Portslade**

Guide Price £300,000



Hazel Close, Portslade

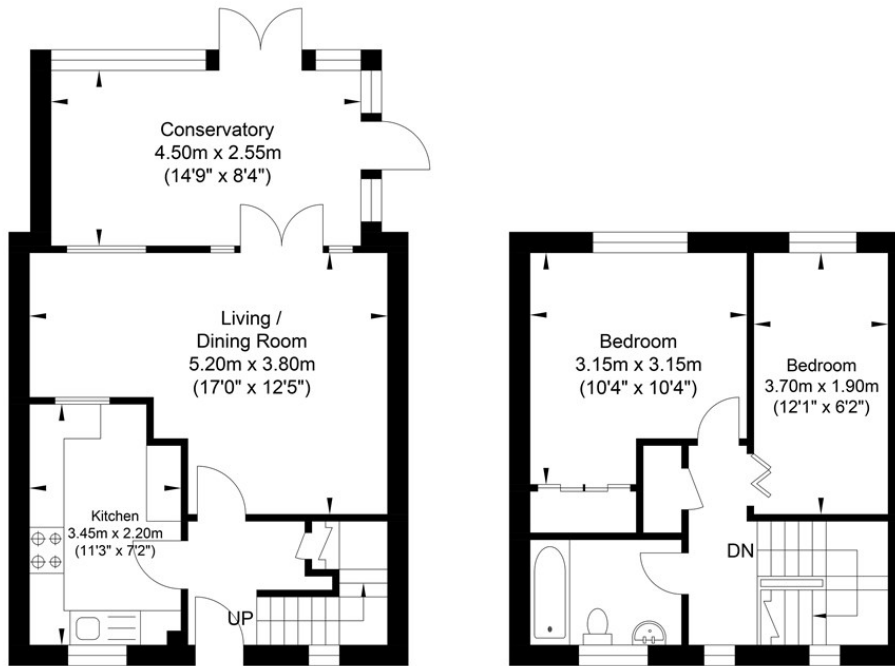

Ground Floor
Approximate Floor Area
447.45 sq ft
(41.57 sq m)

First Floor
Approximate Floor Area
319.04 sq ft
(29.64 sq m)



Approximate Gross Internal Area = 71.21 sq m / 766.49 sq ft
Illustration for identification purposes only, measurements are approximate, not to scale.

DIRECTIONS

CONTACT

Kendrick Property Services - Brighton
10-12 Lewes Road
Brighton
East Sussex
BN2 3HP

E:
sales@kendrickpropertyservices.co.uk
T: 01273 600162
www.kendrickpropertyservices.co.uk

Energy Efficiency Rating		
	Current	Potential
Very energy efficient - lower running costs		
(92 plus) A		
(81-91) B		
(69-80) C		
(55-68) D		
(39-54) E		
(21-38) F		
(1-20) G		
Not energy efficient - higher running costs		
England & Wales EU Directive 2002/91/EC		

